

This document, together with the concepts and designs presented herein, is intended only for the specific purpose and client for which it was prepared. Reuse of and improper reliance on this document without written authorization and adaptation by Kinney-Horn and Associates, Inc. shall be without liability to Kinney-Horn and Associates, Inc.

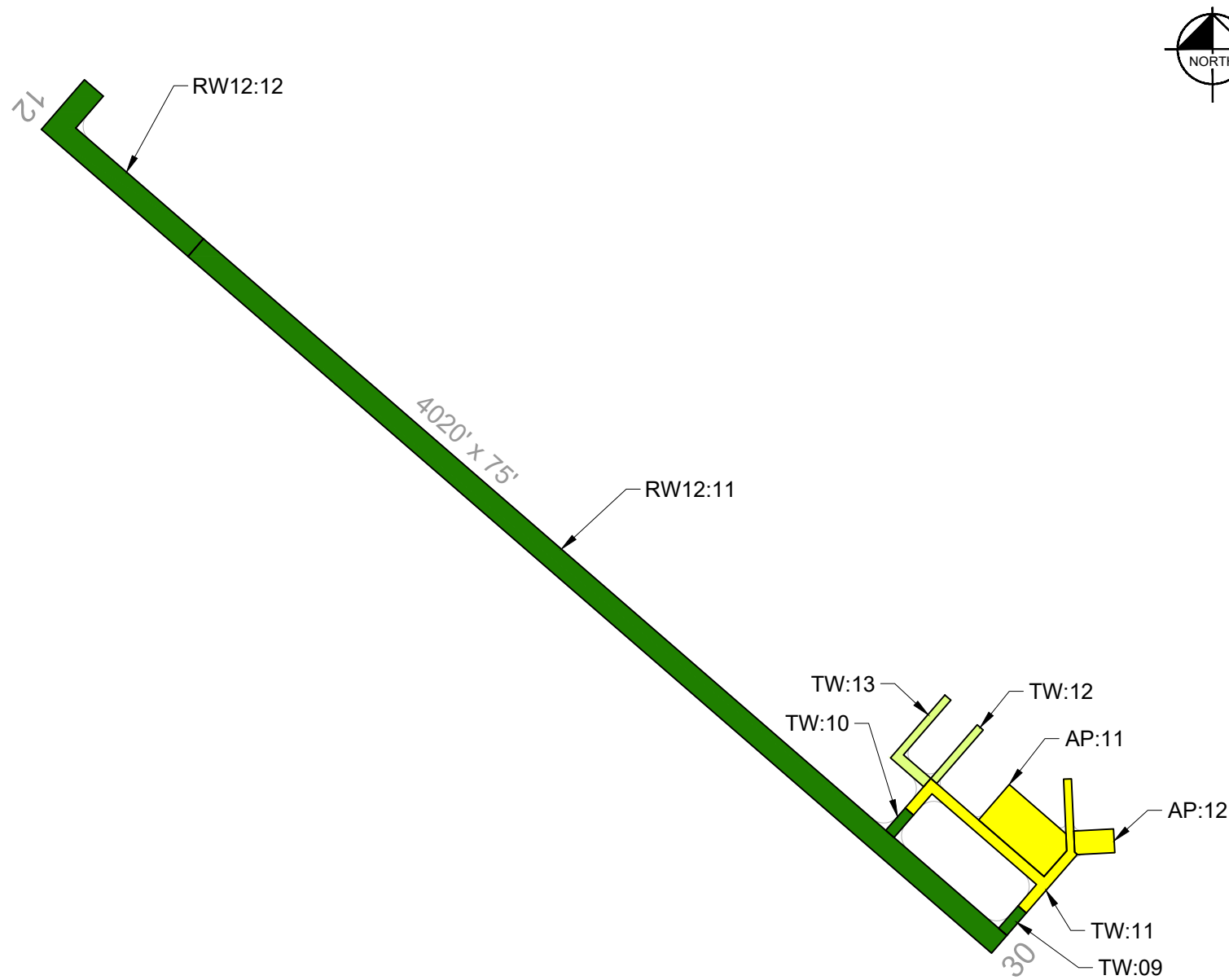

LEGEND

BRANCH IDENTIFIER	
RW01:10	SECTION IDENTIFIER
—	SECTION BOUNDARY
	PCI 86-100 GOOD
	PCI 71-85 SATISFACTORY
	PCI 56-70 FAIR
	PCI 41-55 POOR
	PCI 26-40 VERY POOR
	PCI 11-25 SERIOUS
	PCI 0-10 FAILED

CURRENT 2024 PAVEMENT CONDITION INDEX

Branch ID	Section ID	Branch Name	Surface Type	Section Area (SF)	Approx. Age at Inspection	Last Major Work Date	Last Inspection Date	Pavement Condition Index	PCI Category
RW12	11	Runway 12-30	AAC	255,000	5.9	1/1/2019	9/24/2024	94	Good
RW12	12	Runway 12-30	AAC	46,500	5.9	1/1/2019	9/24/2024	95	Good
TW	09	Taxiway	AAC	3,325	5.9	1/1/2019	9/24/2024	93	Good
TW	10	Taxiway	AAC	3,325	5.9	1/1/2019	9/24/2024	94	Good
TW	11	Taxiway	AC	24,281	26.3	8/1/1998	9/24/2024	63	Fair
TW	12	Taxiway	AC	5,750	26.3	8/1/1998	9/24/2024	73	Satisfactory
TW	13	Taxiway	AC	12,577	21.3	8/1/2003	9/24/2024	77	Satisfactory
AP	11	Apron	AC	46,500	26.3	8/1/1998	9/24/2024	61	Fair
AP	12	Apron	AC	9,728	26.3	8/1/1998	9/24/2024	66	Fair

AIRFIELD PAVEMENT WORK HISTORY

- ADAP-01, 1979, CONSTRUCT RUNWAY EXTENSION, CONNECTING TAXIWAY, AND APRON EXTENSIONS; RESURFACE RUNWAY, TAXIWAY, AND APRON.
- AIP-001-1985, REHABILITATE ALL PAVEMENTS.
- AIP-002-1998, RECONSTRUCT RUNWAY, TAXIWAYS, AND APRON; CONSTRUCT HANGAR ACCESS TAXIWAY (T-12).
- AIP-003-2003, CONSTRUCT HANGAR ACCESS TAXIWAY (T-13); CRACK SEAL, FOG SEAL, AND REMARK ALL PAVEMENTS.
- AIP-006-2010, CRACK SEAL, FOG SEAL, AND REMARK ALL PAVEMENTS.
- AIP-008-2014, CRACK SEAL, SEAL COAT, AND REMARK ALL PAVEMENTS. [MAINTENANCE DONE IN 2015, INSPECTED AFTER PROJECT]
- 2019 RUNWAY 12-30, TW:09 AND TW:10 2" MILL AND OVERLAY. P-401 ASPHALT.
- AIP-015-2023, CRACK SEAL, SEAL COAT, AND REMARK ALL PAVEMENTS.

This document, together with the concepts and designs presented herein, is intended only for the specific purpose and client for which it was prepared. Reuse of and improper reliance on this document without written authorization and adaptation by Kinney-Horn and Associates, Inc. shall be without liability to Kinney-Horn and Associates, Inc.

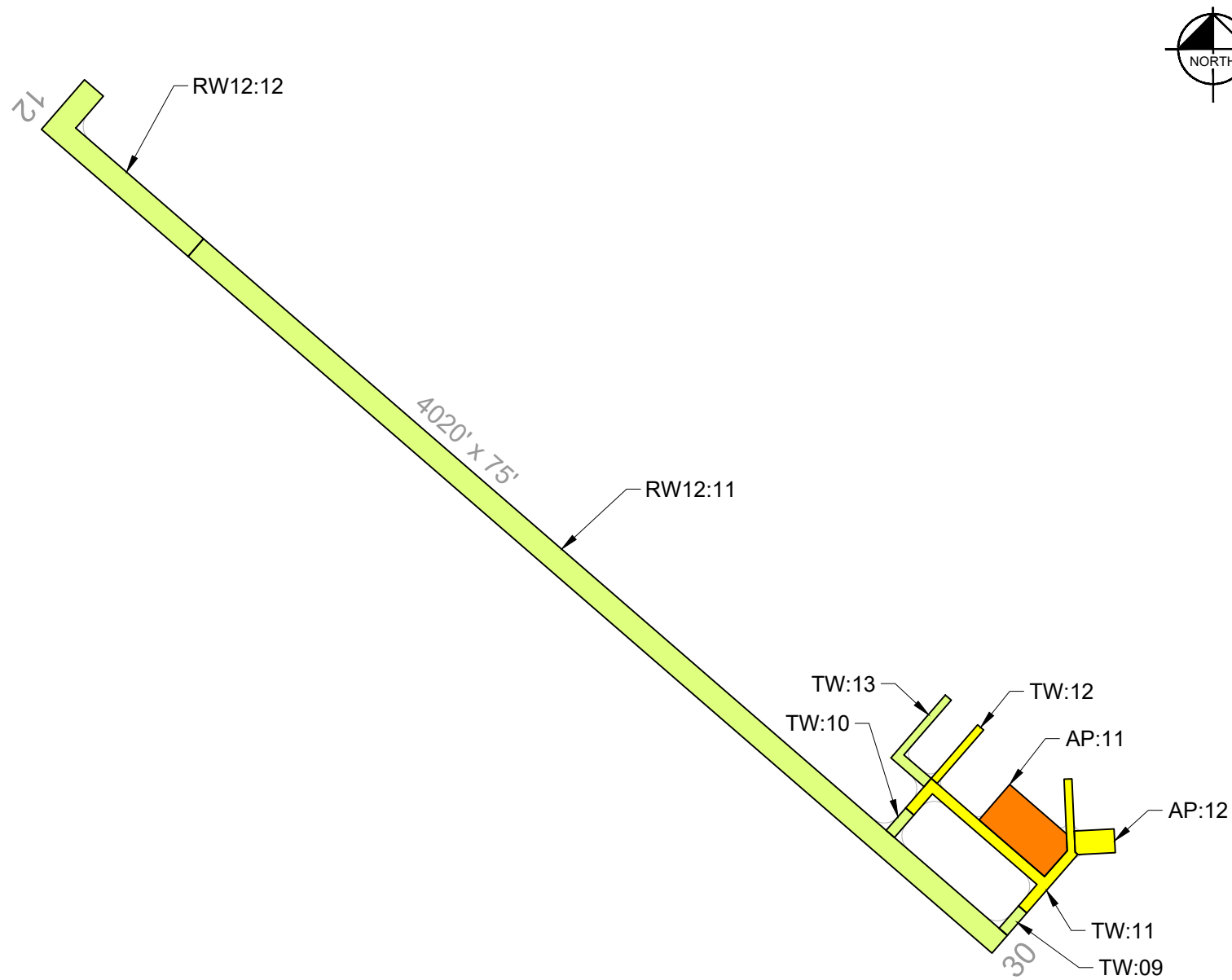

LEGEND

- BRANCH IDENTIFIER
- SECTION IDENTIFIER
- SECTION BOUNDARY
- PCI 86-100 GOOD
- PCI 71-85 SATISFACTORY
- PCI 56-70 FAIR
- PCI 41-55 POOR
- PCI 26-40 VERY POOR
- PCI 11-25 SERIOUS
- PCI 0-10 FAILED

FORECASTED PAVEMENT CONDITION INDEX

Branch ID	Section ID	Surface Type	Current PCI (2024)	2025	2026	2027	2028	2029
RW12	11	AAC	94	93	90	88	86	84
RW12	12	AAC	95	94	91	89	86	85
TW	09	AAC	93	92	90	87	85	83
TW	10	AAC	94	93	90	88	86	84
TW	11	AC	63	63	61	60	58	56
TW	12	AC	73	73	72	71	71	70
TW	13	AC	77	77	76	75	74	73
AP	11	AC	61	61	59	58	57	55
AP	12	AC	66	66	65	64	63	62

This document, together with the concepts and designs presented herein, is intended only for the specific purpose and client for which it was prepared. Reuse of and improper reliance on this document without written authorization and adaptation by Kinney-Horn and Associates, Inc. shall be without liability to Kinney-Horn and Associates, Inc.

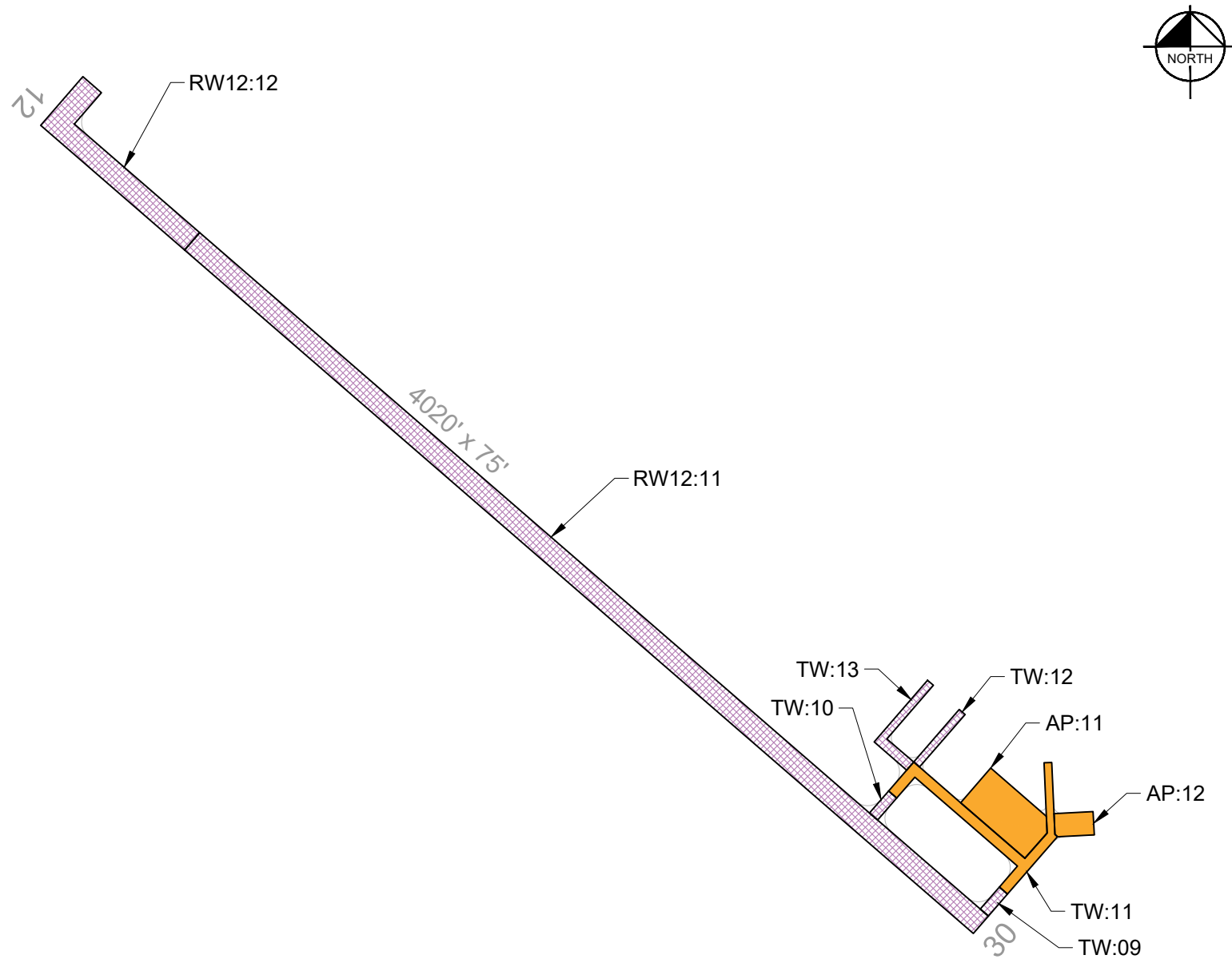

LEGEND

— BRANCH IDENTIFIER
RW01:10 SECTION IDENTIFIER
 — SECTION BOUNDARY

MAJOR REHABILITATION	GLOBAL TREATMENT
2025	2025
2026	2026
2027	2027
2028	2028
2029	2029

5-YEAR PAVEMENT NEEDS BY SECTION

Year	Branch ID	Section ID	Surface Type	Section Area (SF)	PCI at Treatment	Recommended Treatment	Treatment Category
2025	TW	11	AC	24,281	63	Mill and Overlay	Major Rehabilitation
2025	AP	11	AC	46,500	61	Mill and Overlay	Major Rehabilitation
2025	AP	12	AC	9,728	66	Mill and Overlay	Major Rehabilitation
2028	RW12	11	AAC	255,000	86	Crack Seal and Seal Coat	Global Treatment
2028	RW12	12	AAC	46,500	86	Crack Seal and Seal Coat	Global Treatment
2028	TW	09	AAC	3,325	85	Crack Seal and Seal Coat	Global Treatment
2028	TW	10	AAC	3,325	86	Crack Seal and Seal Coat	Global Treatment
2028	TW	12	AC	5,750	71	Crack Seal and Seal Coat	Global Treatment
2028	TW	13	AC	12,577	74	Crack Seal and Seal Coat	Global Treatment



Runway



RW12-11-31: L&T Cracking



RW12-12-11: Weathering

Taxiway



TW-11-06: L&T Cracking



TW-13-02: L&T Cracking

Apron



AP-11-01: L&T Cracking



AP-12-02: Overview

Re-Inspection Report

MDT SASP 2024

Generated Date 1/7/2025

Page 1 of 9

Network: 9S2 **Name:** Scobey Airport

Branch: AP **Name:** Apron **Use:** APRON **Area:** 56,228 SqFt

Section: 11 of 2 **From:** MAIN APRON **To:** **Last Const.:** 8/1/1998

Surface: AC **Family:** _MDT2024 - AP AC **Zone:** SCOB **Category:** D **Rank:** P

Area: 46,500 SqFt **Length:** 310 Ft **Width:** 150 Ft

Slabs: **Slab Length:** Ft **Slab Width:** Ft **Joint Length:** Ft

Shoulder: **Street Type:** ACN **Grade:** 0 **Lanes:** 0

Section Comments:

Work Date: 8/1/1998 **Work Type:** New Construction - Initial **Code:** NU-IN **Is Major M&R:** True

Work Date: 1/1/2023 **Work Type:** Surface Treatment - Seal Coat **Code:** ST-SC **Is Major M&R:** False

Work Date: 1/1/2023 **Work Type:** Crack Sealing - AC **Code:** CS-AC **Is Major M&R:** False

Last Insp. Date: 9/24/2024 **Total Samples:** 9 **Surveyed:** 4

Conditions: PCI: 61

Inspection Comments:

Sample Number: 01 **Type:** R **Area:** 5100.00 SqFt **PCI:** 57

Sample Comments:

41 ALLIGATOR CR L 12.00 SqFt
48 L & T CR L 728.00 Ft
48 L & T CR M 94.00 Ft
57 WEATHERING L 2550.00 SqFt

Sample Number: 04 **Type:** R **Area:** 5100.00 SqFt **PCI:** 63

Sample Comments:

41 ALLIGATOR CR L 6.00 SqFt
48 L & T CR L 661.00 Ft
57 WEATHERING L 2550.00 SqFt

Sample Number: 06 **Type:** R **Area:** 5100.00 SqFt **PCI:** 62

Sample Comments:

48 L & T CR L 735.00 Ft
48 L & T CR M 87.00 Ft
57 WEATHERING L 2550.00 SqFt

Sample Number: 07 **Type:** R **Area:** 5100.00 SqFt **PCI:** 63

Sample Comments:

48 L & T CR L 971.00 Ft
57 WEATHERING L 5100.00 SqFt

Network: 9S2 **Name:** Scobey Airport

Branch: AP **Name:** Apron **Use:** APRON **Area:** 56,228 SqFt

Section: 12 of 2 **From:** EAST APRON **To:** **Last Const.:** 8/1/1998

Surface: AC **Family:** _MDT2024 - AP AC **Zone:** SCOB **Category:** D **Rank:** P

Area: 9,728 SqFt **Length:** 128 Ft **Width:** 76 Ft

Slabs: **Slab Length:** Ft **Slab Width:** Ft **Joint Length:** Ft

Shoulder: **Street Type:** ACN **Grade:** 0 **Lanes:** 0

Section Comments:

Work Date: 8/1/1998 **Work Type:** New Construction - Initial **Code:** NU-IN **Is Major M&R:** True

Work Date: 1/1/2023 **Work Type:** Surface Treatment - Seal Coat **Code:** ST-SC **Is Major M&R:** False

Work Date: 1/1/2023 **Work Type:** Crack Sealing - AC **Code:** CS-AC **Is Major M&R:** False

Last Insp. Date: 9/24/2024 **TotalSamples:** 2 **Surveyed:** 2

Conditions: PCI: 66

Inspection Comments:

Sample Number: 01 **Type:** R **Area:** 4480.00 SqFt **PCI:** 64

Sample Comments:

41 ALLIGATOR CR L 24.00 SqFt

48 L & T CR L 536.00 Ft

57 WEATHERING L 2240.00 SqFt

Sample Number: 02 **Type:** R **Area:** 4480.00 SqFt **PCI:** 67

Sample Comments:

45 DEPRESSION L 36.00 SqFt

48 L & T CR L 385.00 Ft

52 RAVELING L 18.00 SqFt

57 WEATHERING L 2231.00 SqFt

Network:	9S2	Name:	Scobey Airport						
Branch:	RW12	Name:	Runway 12-30	Use:	RUNWAY	Area:	301,500 SqFt		
Section:	11	of 2	From:	STA 26+00	To:	STA 60+00	Last Const.:	1/1/2019	
Surface:	AAC	Family:	_MDT2024 - RW AC AAC	Zone:	SCOB	Category:	D	Rank:	P
Area:	255,000 SqFt	Length:	3,400 Ft	Width:	75 Ft				
Slabs:	Slab Length:	Ft	Slab Width:	Ft	Joint Length:	Ft			
Shoulder:	Street Type:	ACR	Grade:	0	Lanes:	0			
Section Comments:									
Work Date:	8/1/1998	Work Type:	New Construction - Initial		Code:	NU-IN	Is Major M&R:	True	
Work Date:	1/1/2019	Work Type:	Overlay-AC		Code:	OL-AC	Is Major M&R:	True	
Work Date:	1/1/2023	Work Type:	Surface Treatment - Seal Coat		Code:	ST-SC	Is Major M&R:	False	
Work Date:	1/1/2023	Work Type:	Crack Sealing - AC		Code:	CS-AC	Is Major M&R:	False	
Last Insp. Date:	9/24/2024	TotalSamples:	52	Surveyed:	6				
Conditions:	PCI:	94							
Inspection Comments:									
Sample Number:	05	Type:	R	Area:	4875.00 SqFt	PCI:	97		
Sample Comments:									
48	L & T CR	L	13.00	Ft					
Sample Number:	15	Type:	R	Area:	4875.00 SqFt	PCI:	93		
Sample Comments:									
48	L & T CR	L	82.00	Ft					
Sample Number:	20	Type:	R	Area:	4875.00 SqFt	PCI:	92		
Sample Comments:									
48	L & T CR	L	108.00	Ft					
Sample Number:	31	Type:	R	Area:	4875.00 SqFt	PCI:	94		
Sample Comments:									
48	L & T CR	L	76.00	Ft					
Sample Number:	40	Type:	R	Area:	4875.00 SqFt	PCI:	93		
Sample Comments:									
48	L & T CR	L	88.00	Ft					
Sample Number:	51	Type:	R	Area:	4875.00 SqFt	PCI:	96		
Sample Comments:									
48	L & T CR	L	15.00	Ft					

Network:	9S2	Name:	Scobey Airport				
Branch:	RW12	Name:	Runway 12-30	Use:	RUNWAY	Area:	301,500 SqFt
Section:	12	of 2	From:	STA 19+80	To:	STA 26+00	Last Const.: 1/1/2019
Surface:	AAC	Family:	_MDT2024 - RW AC AAC	Zone:	SCOB	Category:	D
Area:	46,500 SqFt	Length:	620 Ft	Width:	75 Ft	Rank:	P
Slabs:	Slab Length:	Ft	Slab Width:	Ft	Joint Length:	Ft	
Shoulder:	Street Type:	ACR	Grade:	0	Lanes:	0	
Section Comments:							
Work Date:	8/1/1998	Work Type:	New Construction - Initial		Code:	NU-IN	Is Major M&R: True
Work Date:	1/1/2019	Work Type:	Overlay-AC		Code:	OL-AC	Is Major M&R: True
Work Date:	1/1/2023	Work Type:	Crack Sealing - AC		Code:	CS-AC	Is Major M&R: False
Work Date:	1/1/2023	Work Type:	Surface Treatment - Seal Coat		Code:	ST-SC	Is Major M&R: False
Last Insp. Date:	9/24/2024	TotalSamples:	11	Surveyed:	5		
Conditions:	PCI: 95						
Inspection Comments:							
Sample Number:	01	Type:	R	Area:	4875.00 SqFt	PCI:	96
Sample Comments:							
48	L & T CR	L	22.00	Ft			
Sample Number:	05	Type:	R	Area:	4875.00 SqFt	PCI:	92
Sample Comments:							
48	L & T CR	L	109.00	Ft			
Sample Number:	08	Type:	R	Area:	4875.00 SqFt	PCI:	92
Sample Comments:							
48	L & T CR	L	101.00	Ft			
Sample Number:	10	Type:	R	Area:	4875.00 SqFt	PCI:	100
Sample Comments:							
<No Distress>							
Sample Number:	11	Type:	R	Area:	5440.00 SqFt	PCI:	96
Sample Comments:							
48	L & T CR	L	34.00	Ft			

Network:	9S2	Name:	Scobey Airport						
Branch:	TW	Name:	Taxiway	Use:	TAXIWAY	Area:	49,258 SqFt		
Section:	09	of 5	From:	R-11	To:	T-12, A-11, & A-12	Last Const.:	1/1/2019	
Surface:	AAC	Family:	_MDT2024 - TW AAC	Zone:	SCOB	Category:	D	Rank:	P
Area:	3,325 SqFt	Length:	95 Ft	Width:	35 Ft				
Slabs:		Slab Length:	Ft	Slab Width:	Ft	Joint Length:	Ft		
Shoulder:		Street Type:	ACR	Grade:	0	Lanes:	0		
Section Comments:									
Work Date:	8/1/1998	Work Type:	New Construction - Initial		Code:	NU-IN	Is Major M&R:	True	
Work Date:	1/1/2019	Work Type:	Overlay-AC		Code:	OL-AC	Is Major M&R:	True	
Work Date:	1/1/2023	Work Type:	Crack Sealing - AC		Code:	CS-AC	Is Major M&R:	False	
Work Date:	1/1/2023	Work Type:	Surface Treatment - Seal Coat		Code:	ST-SC	Is Major M&R:	False	
Last Insp. Date:	9/24/2024	TotalSamples:	1	Surveyed:	1				
Conditions:	PCI: 93								
Inspection Comments:									
Sample Number:	01	Type:	R	Area:	3325.00 SqFt	PCI:	93		
Sample Comments:									
48	L & T CR	L	67.00	Ft					

Network:	9S2	Name:	Scobey Airport						
Branch:	TW	Name:	Taxiway	Use:	TAXIWAY	Area:	49,258 SqFt		
Section:	10	of 5	From:	R-11	To:	T-12, A-11, & A-12	Last Const.:	1/1/2019	
Surface:	AAC	Family:	_MDT2024 - TW AAC	Zone:	SCOB	Category:	D	Rank:	P
Area:	3,325 SqFt	Length:	95 Ft	Width:	35 Ft				
Slabs:	Slab Length:	Ft	Slab Width:	Ft	Joint Length:	Ft			
Shoulder:	Street Type:	ACR	Grade:	0	Lanes:	0			
Section Comments:									
Work Date:	8/1/1998	Work Type:	New Construction - Initial		Code:	NU-IN	Is Major M&R:	True	
Work Date:	1/1/2019	Work Type:	Overlay-AC		Code:	OL-AC	Is Major M&R:	True	
Work Date:	1/1/2023	Work Type:	Surface Treatment - Seal Coat		Code:	ST-SC	Is Major M&R:	False	
Work Date:	1/1/2023	Work Type:	Crack Sealing - AC		Code:	CS-AC	Is Major M&R:	False	
Last Insp. Date:	9/24/2024	TotalSamples:	1	Surveyed:	1				
Conditions:	PCI: 94								
Inspection Comments:									
Sample Number:	01	Type:	R	Area:	3325.00 SqFt	PCI:	94		
Sample Comments:									
48	L & T CR	L	45.00	Ft					

Network:	9S2	Name:	Scobey Airport						
Branch:	TW	Name:	Taxiway	Use:	TAXIWAY	Area:	49,258 SqFt		
Section:	11	of 5	From:	R-11	To:	T-12, A-11, & A-12	Last Const.:	8/1/1998	
Surface:	AC	Family:	_MDT2024 - TW AC	Zone:	SCOB	Category:	D	Rank:	P
Area:	24,281 SqFt	Length:	512 Ft	Width:	125 Ft				
Slabs:	Slab Length:	Ft	Slab Width:	Ft	Joint Length:	Ft			
Shoulder:	Street Type:	ACR	Grade:	0	Lanes:	0			
Section Comments:									
Work Date:	8/1/1998	Work Type:	New Construction - Initial		Code:	NU-IN	Is Major M&R:	True	
Work Date:	1/1/2023	Work Type:	Crack Sealing - AC		Code:	CS-AC	Is Major M&R:	False	
Work Date:	1/1/2023	Work Type:	Surface Treatment - Seal Coat		Code:	ST-SC	Is Major M&R:	False	
Last Insp. Date:	9/24/2024	TotalSamples:	6	Surveyed:	4				
Conditions:	PCI: 63								
Inspection Comments:									
Sample Number:	01	Type:	R	Area:	5000.00 SqFt	PCI:	61		
Sample Comments:									
48	L & T CR	L	784.00	Ft					
48	L & T CR	M	20.00	Ft					
57	WEATHERING	L	2500.00	SqFt					
Sample Number:	02	Type:	R	Area:	5145.00 SqFt	PCI:	64		
Sample Comments:									
48	L & T CR	L	657.00	Ft					
48	L & T CR	M	20.00	Ft					
57	WEATHERING	L	2572.00	SqFt					
Sample Number:	03	Type:	R	Area:	5180.00 SqFt	PCI:	66		
Sample Comments:									
48	L & T CR	L	537.00	Ft					
48	L & T CR	M	17.00	Ft					
57	WEATHERING	L	2590.00	SqFt					
Sample Number:	07	Type:	R	Area:	3962.00 SqFt	PCI:	61		
Sample Comments:									
41	ALLIGATOR CR	L	50.00	SqFt					
48	L & T CR	L	435.00	Ft					
48	L & T CR	M	25.00	Ft					
57	WEATHERING	L	1981.00	SqFt					

Network:	9S2	Name:	Scobey Airport						
Branch:	TW	Name:	Taxiway	Use:	TAXIWAY	Area:	49,258 SqFt		
Section:	12	of 5	From:	T-1	To:	HANGARS	Last Const.:	8/1/1998	
Surface:	AC	Family:	_MDT2024 - TW AC	Zone:	SCOB	Category:	D	Rank:	P
Area:	5,750 SqFt	Length:	230 Ft	Width:	25 Ft				
Slabs:	Slab Length:	Ft	Slab Width:	Ft	Joint Length:	Ft			
Shoulder:	Street Type:	ACR	Grade:	0	Lanes:	0			
Section Comments:									
Work Date:	8/1/1998	Work Type:	New Construction - Initial		Code:	NU-IN	Is Major M&R:	True	
Work Date:	1/1/2023	Work Type:	Crack Sealing - AC		Code:	CS-AC	Is Major M&R:	False	
Work Date:	1/1/2023	Work Type:	Surface Treatment - Seal Coat		Code:	ST-SC	Is Major M&R:	False	
Last Insp. Date:	9/24/2024	TotalSamples:	1	Surveyed:	1				
Conditions:	PCI:	73							
Inspection Comments:									
Sample Number:	01	Type:	R	Area:	5625.00 SqFt	PCI:	73		
Sample Comments:									
48	L & T CR	L	526.00	Ft					
57	WEATHERING	L	5625.00	SqFt					

Network: 9S2 **Name:** Scobey Airport

Branch: TW **Name:** Taxiway **Use:** TAXIWAY **Area:** 49,258 SqFt

Section: 13 of 5 **From:** T-11 **To:** HANGARS **Last Const.:** 8/1/2003

Surface: AC **Family:** _MDT2024 - TW AC **Zone:** SCOB **Category:** D **Rank:** P

Area: 12,577 SqFt **Length:** 374 Ft **Width:** 25 Ft

Slabs: **Slab Length:** Ft **Slab Width:** Ft **Joint Length:** Ft

Shoulder: **Street Type:** ACR **Grade:** 0 **Lanes:** 0

Section Comments:

Work Date: 8/1/2003 **Work Type:** New Construction - Initial **Code:** NU-IN **Is Major M&R:** True

Work Date: 1/1/2023 **Work Type:** Crack Sealing - AC **Code:** CS-AC **Is Major M&R:** False

Work Date: 1/1/2023 **Work Type:** Surface Treatment - Seal Coat **Code:** ST-SC **Is Major M&R:** False

Last Insp. Date: 9/24/2024 **TotalSamples:** 2 **Surveyed:** 2

Conditions: PCI: 77

Inspection Comments:

Sample Number: 01 **Type:** R **Area:** 4025.00 SqFt **PCI:** 67

Sample Comments:

48 L & T CR L 415.00 Ft

52 RAVELING L 105.00 SqFt

57 WEATHERING L 3920.00 SqFt

Sample Number: 02 **Type:** R **Area:** 6700.00 SqFt **PCI:** 83

Sample Comments:

48 L & T CR L 267.00 Ft

57 WEATHERING L 6700.00 SqFt